

미술관 일기

Museum Recollections

2022. 04. 15 ~ 07. 31

Celebrating the 30th anniversary, *Museum Recollections* highlights the past 200 exhibitions in chronological order and recollects the past 30 years of the Whanki Museum's history, reframing the collection of artworks and archives.

For the first decade from 1992 to 2003, the exhibitions of the Whanki Museum are featured to fulfil a vision of the Whanki Foundation and build up Whanki's archive classifying by material, medium, and theme of Whanki's work. The exhibitions include "Prix Whanki"; and a series of "Whanki Foundation Artists," "Keunwon and Suwha" which is the starting point of the "Whanki and his contemporaries" series; "Oil on Newspaper 1967~1968" and "For HyangAn" were drawn public attention.

Since 2004, when the founder Kim HyangAn passed away, the Whanki Museum has expanded its role as a contemporary art museum based on its identity as the research institute of KIM Whanki. Selected exhibitions include "The Poetics of Space: Transparency and Virtuality" which is continued as the current space projects; "Livre Object (3 Book Artists Abroad)" that introduced the genre of book-art which was unfamiliar at the time; and "Buam-dong Art Project" with local artists and residents of Buam-dong where the museum is located. Since then, the museum has conducted "KIM Whanki, the Aesthetics of Colors" by analyzing the pigments of colors that were used for his works in the early 70s through scientific methodology; "The Poetics of KIM Whanki" by reinterpreting of KIM Whanki's aesthetics through the theory of poetry; and the "Whanki Museum Highlights" to solidify the identity of the museum focusing on the main collection of the Whanki Museum.

1F

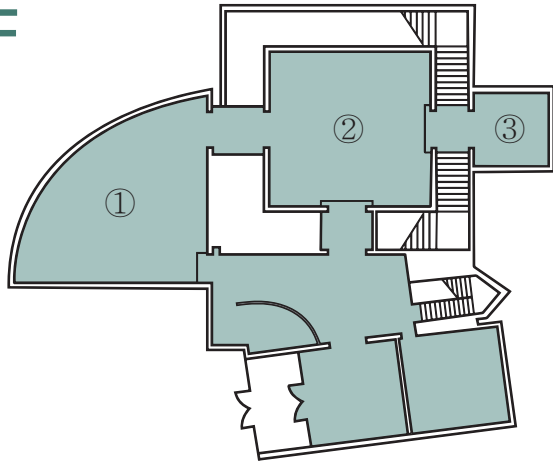

Chapter 1. Whanki Museum, The Beginning of History

- ① 30 Years of the Whanki Museum through archive resources
- ② Hommage Exhibition of Grand Opening of the Whanki Museum in 1993
- ③ Recreated Images of KIM Whanki for the Whanki Museum

The Main Building opened on November 5, 1992. The Annex where an art shop and a special gallery are located was opened on following year and the Suhyangsanbang where an education center and a gallery are located opened in 1997.

The imagery of early years of the Whanki Museum was revived based on the archives of the Grand Opening of the Whanki Museum in 1993.

Chapter 2. Whanki Foundation Legacy

- ④ The Prix Whanki
- ⑤ Whanki Foundation Artists

The Whanki Foundation and Whanki Museum has supported various creative activities of young artists since the 1970s. One of the main programs of the Whanki Foundation, the “*Prix Whanki*” and “*Whanki Foundation artists*” supporting program, has carried on as the exhibition program of the Whanki Museum. This category aims to envision and significance of the Whanki Foundation.

2F

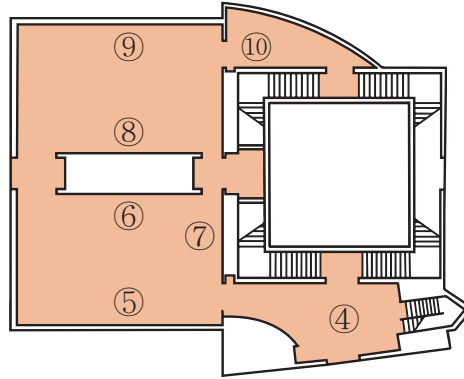

Chapter 3. Early Research based exhibition on KIM Whanki

- ⑥ The exhibition of Oil on Newspaper 1967~1968
- ⑦ Whanki's Collage
- ⑧ Publication of Whanki's Gouache series *For HyangAn*

For more than a decade since its opening in 1992, the foundation of Whanki's archive has developed through research on Whanki's works by subject, medium, and material. As many exhibitions and publications were conducted at that time, it represents here the traces of early research activities in scoping its major exhibitions and publications.

Chapter 4. Beyond the Museum of KIM Whanki

- ⑨ Art Project for intercommunication of contemporary art with audiences
- ⑩ From Whanki's artistic Book covers to works of Book-Art

Since the mid-2000s, the museum has expanded its role through various attempts to carry out as a contemporary art museum based on its identity as a research institute, including the *Buam-dong Art Project* which tells the stories of local residents with local artists. As Whanki drew many book art covers, Whanki Museum organized exhibitions about one of the contemporary art genres 'Book-Art' in the 2000s.

3F

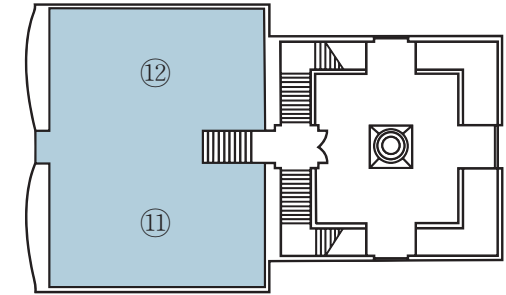

Chapter 5. With new perspectives

- ⑪ The exhibition KIM Whanki, the Aesthetics of Color
- ⑫ Visitor Selected Whanki Museum collections via SNS.

“*KIM Whanki, the Aesthetics of Color*” was a project that provided an opportunity to explore the palette of KIM Whanki's work and to analyze the pigments of colors through modern technology. The exhibition “*The Whanki Museum Highlights*” was an exhibition not only introduced KIM Whanki's art world through Whanki Museum collection but also re-established the unique feature of the museum.

Annex
2F

Bookmarks of the Whanki Museum

2022.04.15~7.31

Annex 2
Suhyangsanbang

The Story between Us - The Journey to the Whanki Museum

2022.04.15~12.31